

Instruction for Gap Inspection Gauges

Foreword:

On initial installation of FITOK fittings, installer assure the installer or inspector that a fitting has been sufficiently tightened, to clear up the latent danger of leakiness for your system. Available all metal fittings, fractional sizes from 1/16 to 1 inch and metric sizes from 2 to 25 mm.

■ How to use:

Position the FITOK gap inspection gauge next to the gap between the nut and body

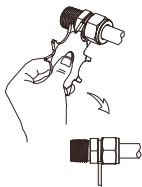

If the gauge will not enter the gap the fitting is sufficiently tightened

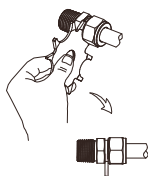

If the gauge will enter the gap additional tightening is required

FITOK

- ⚠ Before translate the tightness of fittings, leak the system's pressure
- ⚠ Do not use to inspect the fittings installed by hydraulic presetting tool
- ⚠ Do not use to inspect the fittings reinstall

FITOK Group

info@fitok.com
www.fitok.com