

Subsea Hydraulic Needle Valves

Features

- Working pressure up to 20,000 psig (1379 bar)
- Maximum external pressure: 6,000 psig (414 bar)
- Hydraulic supply pressure: 3,000 psig (207 bar)
- Working temperature: 0 to 175°F (-18 to 80°C)
- High tensile 316 stainless steel for valve body
- Standard stem seal material: PTFE
- NACE MR0175 optional
- Metal-to-metal seating to ensure ideal shut-off, longer stem/seat service lifetime for abrasive flow, excellent corrosion resistance and greater durability for repeated on/off cycles
- Reliable packing gland locking device
- Wide selection of tube and pipe end fittings available
- 2-way straight and angle flow patterns available
- Orifice: 0.203"
- Rated Cv: 0.75
- Maximum water depth: 13,800 ft. (4200 m)



Standard Materials of Construction

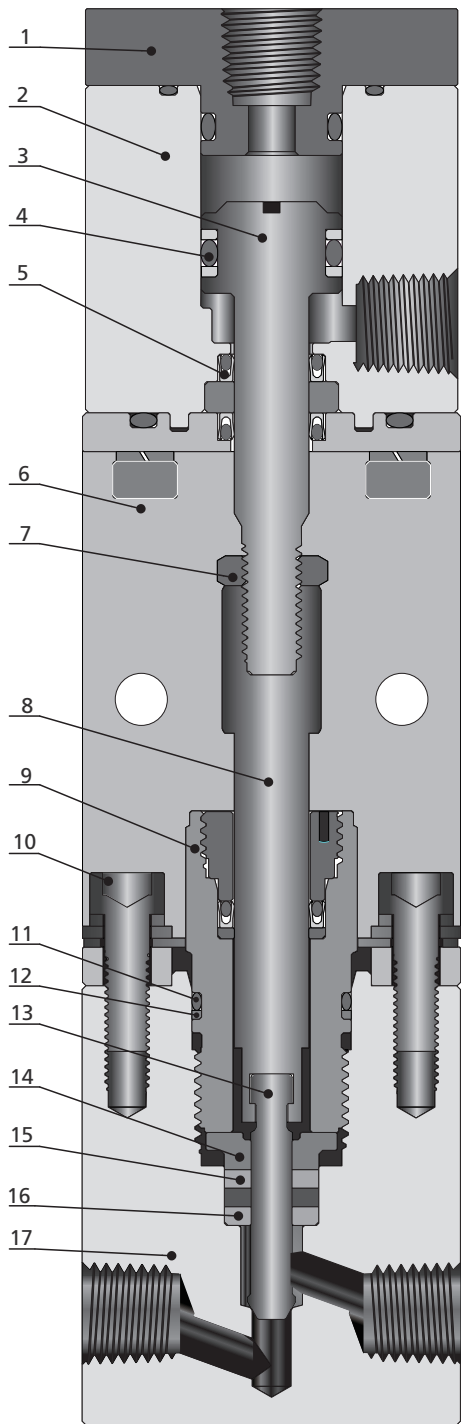

Item	Component	Material Grade
1	Gland	316 SS
2	Actuator Body	316 SS
3	Piston Rod	316 SS
4	O-Ring	Fluorocarbon FKM
5	Piston Seal	UHMWPE
6	Support Block	316 SS
7	Nut	Stainless Steel
8	Upper Stem	316 SS
9	Packing Gland	316 SS
10	Locking Screw	SS
11	O-Ring	NBR
12	O-Ring Retainer	PTFE
13	<i>Lower Stem</i>	<i>S17400</i>
14	Packing Ring	C63000
15	<i>Packing</i>	<i>PTFE</i>
16	<i>Packing Washer</i>	<i>S17400</i>
17	<i>Body</i>	<i>316 SS</i>

Wetted components listed in italics.

Fittings

Tubing

Quick Couplings

Line Filters

Valves

Sour Service Products

Subsea Valves

Part Number Crossover Charts

Ordering Number Description

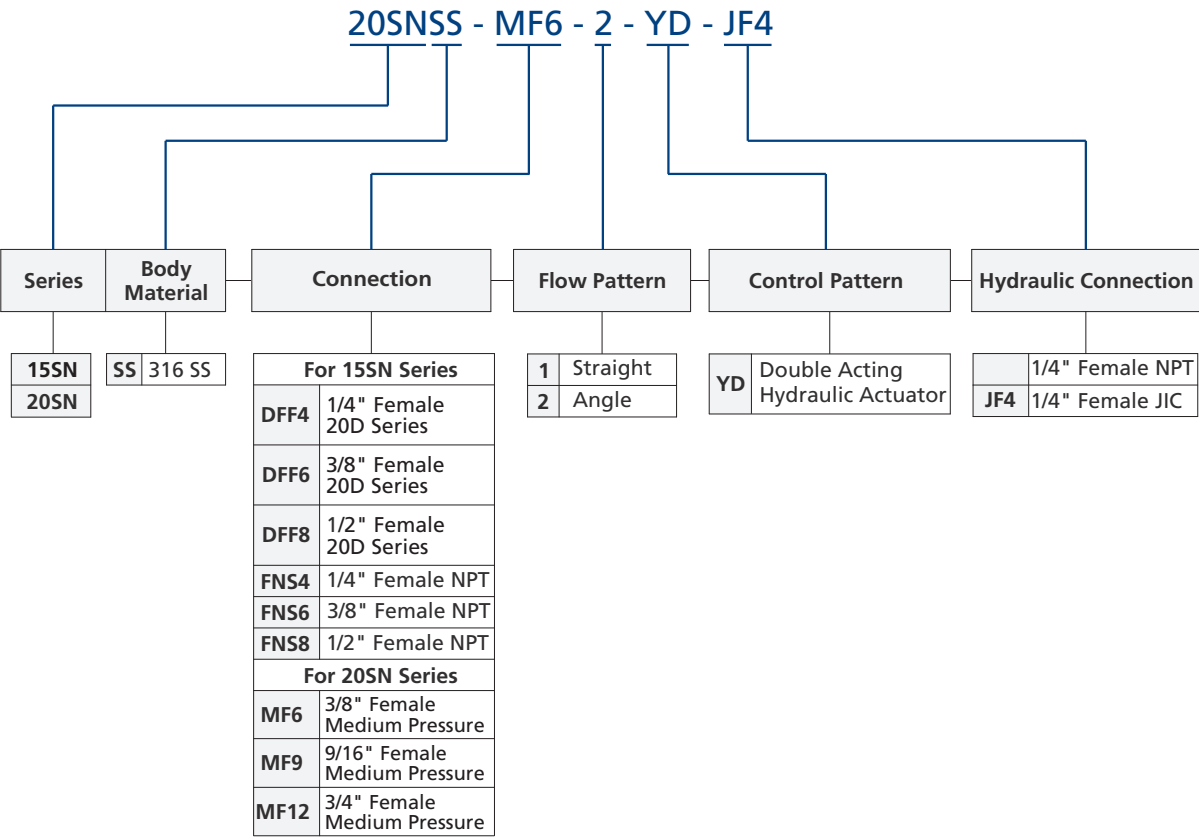

- Notes: 1. For more details regarding 20D Series and Medium Pressure connections, please see **Connection Information** on A-02.
2. "Ordering Number Description" is a reference to understand the combination rules of FITOK product part number. Not all combinations are available.